

ALUTILE[®]
SINCE 1995



3A Panel (Aluminum Core Panel)

All-metal material,
the best choice of high-end fabricated wall panel.

TiO₂ Coating
30 Years
Color Preserving

Full Dimension
Structure
50 years warranty



Environmental Protection, Zero Formaldehyde Release

Zero release of toxicity, such as formaldehyde, benzene, VOC and etc., 3A panel's production meets the national environmental standards.



Stable Structure, High Evenness

3A panel has a high rigidity-to-weight ratio due to its multilayer metal structure, which makes it more stable and almost unbreakable. It could keep evenness even though the panel size is overlarge.



High Impact Resistance & Durable Wear Resistance

The shape of 3A panel's middle layer is hollow Ladder column, distributed evenly makes the panel could bear the highest pressure with the lightest weight. The impact and wear resistance is also much better than traditional wall decoration panel.





Beautiful Decoration, Good Integrity

3A panel has rich colors, especially the natural wood grain color is available for different places and meet the interior decoration requirement.



Simple Fabrication, Fast installation

It's easy to move and the superior fabrication performance creates various styles. Industrial fabrication and fast installation, it can save labor, time and money by quick assembling at construction site.



Mildew Resistance & Antiseptic, Anti-radiation, Anti-static

The full metal structure of 3A panels can avoid the germ and mould, reduce the bacterial infections, and avoid the hurt caused by radiation and electrostatic.



Easy wash and maintain

Perfect self-cleaning, wash by the neutral detergent or water. Keep the panel clean as new for long time.



Superior Fire-resistance Performance, In Accordance with the Fire Protection

The main materials of 3A panel are non-combustible material and fully meet the request of fire protection.



- Airport, high-speed railway, metro, light rail, museums and archives, conference and exhibition center, commercial complexes, high-grade office buildings, hotels and other buildings interior wall decoration and over length strip ($\geq 6m$) for ceiling;



- First choice for functional-requirement machine room, medical operating room, precise instrument room, database's interior and exterior decoration;
- Special decoration for High-speed railway's carriage, yacht, ship's interior decoration.

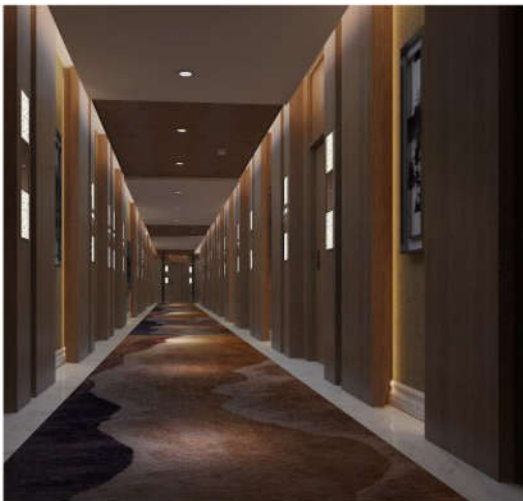



3A Panel Define Good Curtain Wall Panel

Although compounded by three layers of aluminum sheet, over large panel surface is still with perfect evenness. Splicing between panels is natural and smooth, varied decorative face shows multiple wall expression effect, 3A panel possess the advantages of light weight, high strength, fire-resistance and moisture-resistance, pollution-free, prolonged wear-resisting, fast splicing, easy to maintain etc. Especially its middle layer uses concave-convex empty drum structure to decrease thermal conductivity rate and increase a certain thermal bridge partition and sound insulation effect. It's favorite first choice for all kinds of public buildings and commercial buildings interior decoration materials.

Processing Method

Simply used processing tools for timber or metal to cut, saw, mill, fold, bend into arc & reverse arc, small radius corner, inside and outside corner, right angle etc. various shape.



Cutting

3A panel can be cut into various shapes with water jet propeller, profiling milling machine, shaping saw and curving saw.

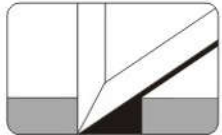

Boring-milling

Through boring- milling processing tools to complete milling, drilling, boring etc. Please note that pad is necessary for all tools.



Drilling

Panel can be drilled by twist drill which usually used for drilling aluminum and plastic.



Bending

Through bending desk or brake-press lathes to finish, bending. Inner diameter can be about 10 times of panel thickness.

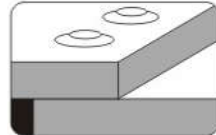

Riveting

Use ordinary equipment, rivet or blind rivet to finish riveting. Need to consider thermal expansion when used for outdoors.

Our Certificates



CE Certificate



SGS Test Report



Intertek
Test Report



ASTM
Standard Test



BS Standard Test



FHWA



ISO9001/ISO14001
System Certificate



International
Astronautical
Federation

JIANGXI ALUTILE BUILDING MATERIALS CO., LTD.

www.alutile.com

Add: No.1155, 2nd Chuangxin Road, State High-Tech. Development Zone, Nanchang, Jiangxi, China. PC: 330096

Tel: +86-791-88162180/88161917/88162161 Fax: +86-791-88162165 E-mail: alutile@alutile.com; alutile@china126.com